

## SHOWERLINE – WALL LINER INSTALLATION GUIDE

### 1. Application of Adhesive (not supplied \*\*\*)

Ensure both surfaces to be bonded are clean, dry and grease free. (We suggest having a blue board backing) Apply bead of adhesive (3 - 5mm thick) in a square pattern of 1000mm centres onto substrate and apply continuous bead (3 - 5mm) within the perimeter line of the wall liner.

Place the lining onto the wall within ten minutes, firmly press the entire sheet with your hands so that full contact is made with all beads of adhesive and brace firmly for at least 18 hours. Brace so that all of the shower liner is flush and level. Shower should not be used for at least 24 hours after the liner has been installed.

Do not apply blobs of adhesive. These will cause unsightly undulations and sheet buckling – clean by using a dry clean cloth. You can use off-cut wallboard and some props placed on a 45° angle to help secure the wall liner to the wall boards.

Our wall liners typically come standard 2000mm high and can be cut down (using a sharp builder's implement, i.e. Stanley knife).

### 4. Glue Pattern

Cut the nozzle on the adhesive cartridge in a “V” shape to allow a 3 – 5 mm raised bead of glue. Apply a bead 10mm inside pencil line marking the perimeter of the wall liner. Starting on the shower rose wall apply vertical lines of adhesive in 5mm beads at intervals of 100mm. Refit wall liner to the marks and starting at the back corner, work from the centre out and compress to ensure ripples are expelled from the glue lines. Push firmly with a soft cloth. Clean excess glue with white spirits. Allow 24 hours to dry and then remove plastic protective film.

### 2. Marking walls for fitting of shower base

Place base on floor and push firmly against wall, mark outline of base on studs. Remove base and notch out stud to allow tile lip to recess under stud (diagram below). Re-fit base and mark centre of waste and outline of base, once again remove base and cut a 50mm hole for waste in the floor. Check that water run off to the outlet is satisfactory. It is important that the underside of the base should be fully supported – for details refer to instructions on base)

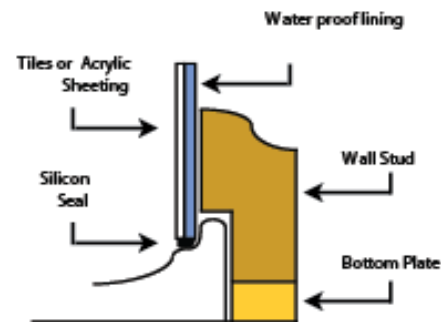

### 5. Handy Hint

You may use some off cut wall board and props placed on 45 degree angles to help secure the wall liner to the wall boards.

Shower system is now ready for the installation of the shower screen (please refer to the separate installation instructions for a shower screen (please remember that it should be fitted by qualified personnel, so as not to void the warranty).

### 3. Marking for Plumbing

Remove the shower wall liner and check with a level that the lines from the edge of the base are vertical. Measure the centre for the shower rose and handles from the lines you marked on the wallboard. Transfer these measurements to the shower wall liner and drill appropriate sized holes. Sand the rear surface of the shower wall liner with heavy grit sandpaper to assist adhesion and dust off. Refit the wall liner to check hole positions.

### Warranty – 12 Months

Wall liners have a one (1) year warranty against any manufacturing defects.

Shower screens have a one (1) year warranty against any manufacturing defects (glass is not covered under any warranty).

Shower bases have a seven (7) year warranty against any manufacturing defects. It is imperative the base be totally supported underneath (they are **NOT** self supporting bases (refer to the shower base installation instructions).

Freestanding baths have a one (1) year warranty against any manufacturing defects.

Please make sure you keep the receipt for your warranty and contact the store you purchased the item from for any warranty issues that may occur. They will contact Showerline on your behalf.

#### \*\*\* Adhesive

Showerline do not provide the adhesive due to the flammable liquids transport legislation. We suggest using a construction adhesive such as Sikaflex.

**Please use the services of qualified personnel (as DIY installers can void the warranty).**